

Zero Point System

Improve the efficiency of machine tools



Multiple benefits for using zero point system

Benefits for consumers

90%

Reduce setup times
by up to 90%

+ 374 h

Additional production
time per year

Save

100000 euros per year
for 5000euros cost

Benefits for reseller

More profits

Resell our products will
increase the net profit by
at least 20%

LOGO custom

Silvercnc can customize
brands for long-term
customers. You only need to
be responsible for brand
promotion and sales

NO Worry quality

After testing the samples,
you will be satisfied with the
quality

Typical zero-point system composition

The zero point system include three key parts: pallet,spigot and plate



3A-110116



3A-110109



3A-400100



3A-400100



3A-400101



3A-400100



3A-400101



3A-400102



3A-400102



3A-110105



3A-110106

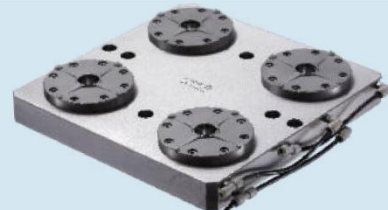

3A-110107



SC-110104

Built-in zero point chuck

Unlocking air pressure: 0.6 MPa .with cleaning and gas detection

Clamping force: Upto15000N

Resetting precision: Less than 0.005mm

Characteristics: Built-in type, embedded in the base plate of the fixture designed by the customer, can lift a 150kg pallet or a workpiece by 1 mm

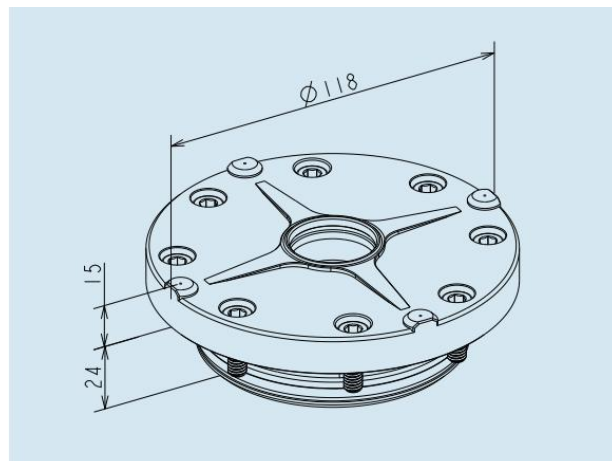

SC-110105

Single zero-point system

Application: Suitable for 63/80/100/125 pitch T slot workbench

Unlocking air pressure: 0.6 MPa .with cleaning and gas detection

Clamping force: Up to15000N

Resetting precision: Less than 0.005mm, with stop groove

Characteristics: Can lift a 150kg pallet or a workpiece by 1 mm

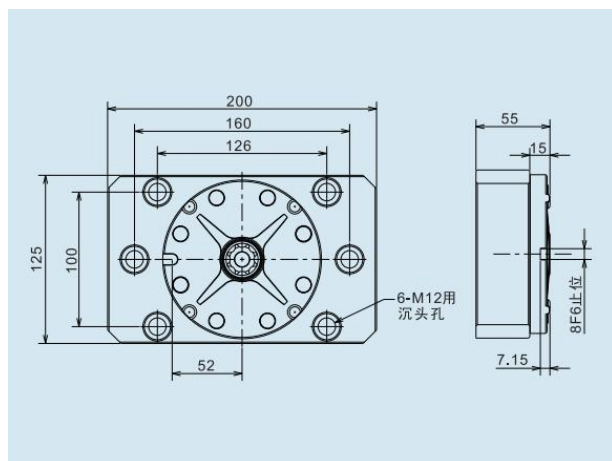

Zero-point positioning system-double

Unlocking air pressure: 0.6 MPa, With cleaning and gas detection

Clamping force: Single chuck can upto 15Q00N

Resetting precision: Less than 0.005mm

Characteristics: Can lift a 150kg pallet or a workpiece by 1mm

Model NO.	L(mm)	A(mm)	W(mm)
SC-110110	330	150	290
SC-110106	380	200	340
SC-110111	430	250	390

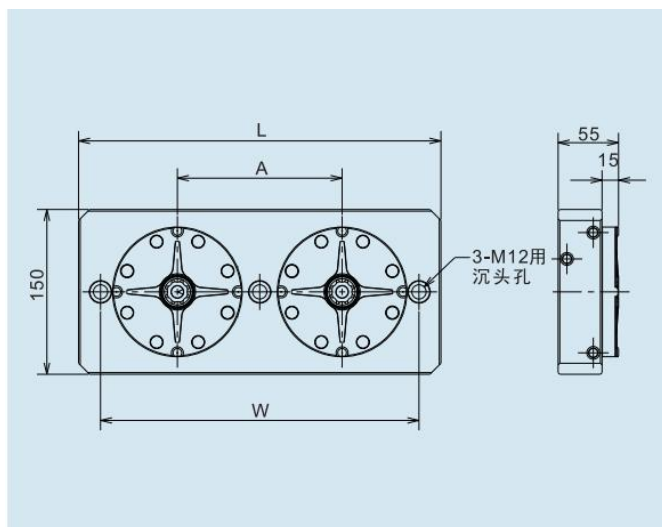

Zero-point system - quatro

Unlocking air pressure: 0.6 MPa, With cleaning and gas detection

Clamping force: Single chuck can upto 15Q00N

Resetting precision: Less than 0.005mm

Characteristics: Can lift a 150kg pallet or a workpiece by 1mm

Model NO.	A(mm) (Center distance)	L(mm)	W(mm)	S(mm)
SC-110107	200	350	320	250
SC-110108	250	430	320	200

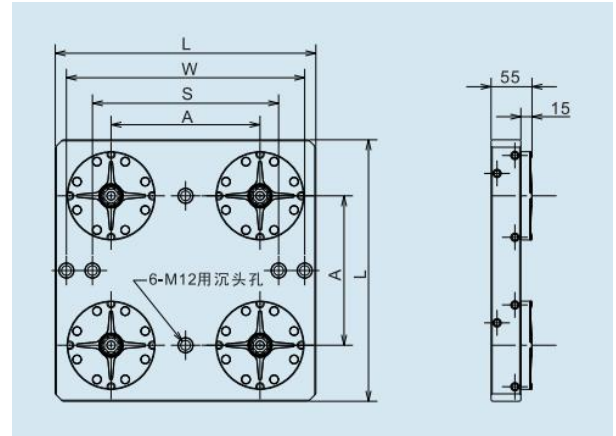

Zero-point system -Hexa

Unlocking air pressure: 0.6 MPa, With cleaning and gas detection

Clamping force: Single chuck can upto 15Q00N

Resetting precision: Less than 0.005mm

Note: Do not damage the air holes when drilling the connecting holes

Characteristics: Can lift a 150kg pallet or a workpiece by 1mm

Model NO.	A(mm) (Center distance)	L(mm)	W(mm)
SC-110120	200	600	380
SC-110121	250	700	430

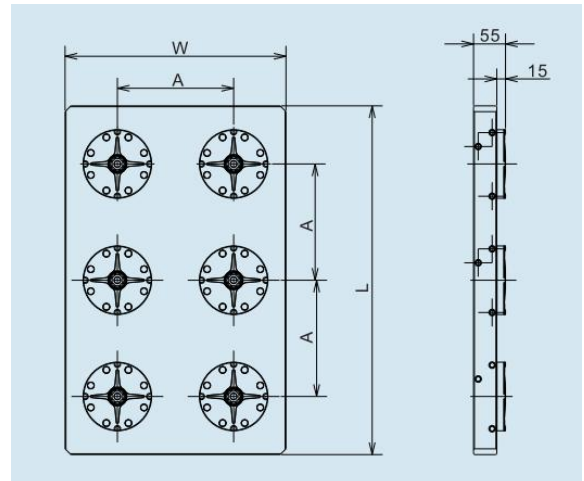

SC-110103

Built-in zero point chuck

Unlocking air pressure: 0.6 MPa, With cleaning and gas detection

Clamping force: Single chuck can up to 15Q00N

Resetting precision: Less than 0.005mm

Characteristics: Built-in type, embedded in the base plate of the fixture designed by the customer, can lift a 150kg pallet or a work piece by 1mm

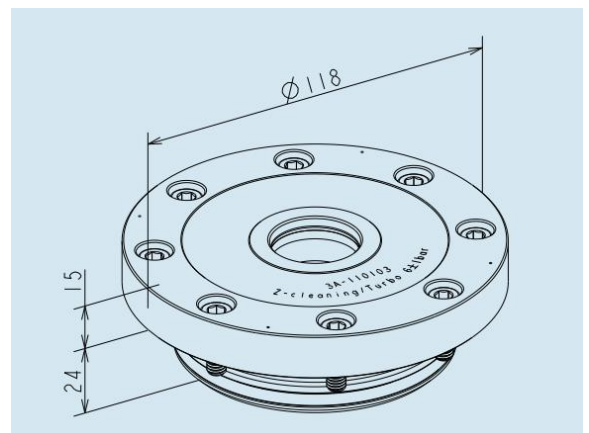

SC-110105P

Single zero-point positioning chuck

Application:Suitable for63/80/100/125 pitch T slot workbench

Unlocking air pressure: 0.6 MPa .with cleaning and gas detection

Clamping force: Up to15000N

Resetting precision: Less than 0.005mm,with stop groove

Characteristics: Can lift a 150kg pallet or a work piece by 1 mm

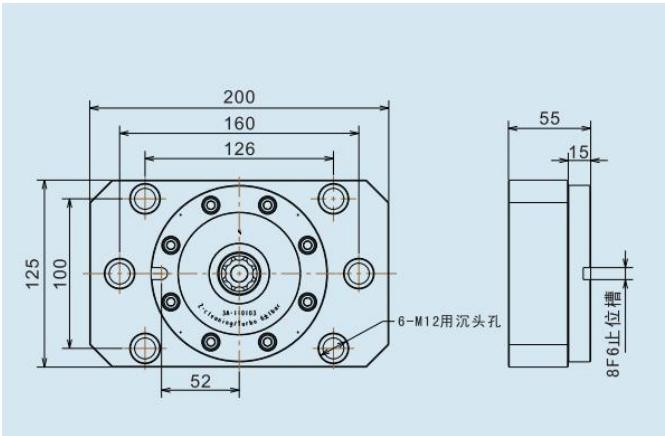

Zero-point system - double

Unlocking air pressure: 0.6 MPa,With cleaning and gas detection

Clamping force: Single chuck can up to 15000N

Resetting precision: Less than 0.005mm

Characteristics: Can lift a 150kg pallet or a work piece by 1mm

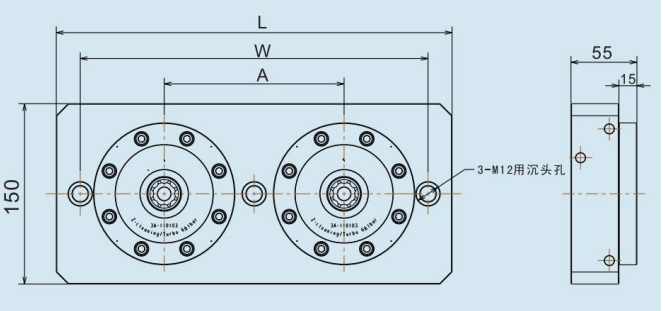

Model NO.	L(mm)	A(mm)	W(mm)
SC-110110P	330	150	290
SC-110106P	380	200	340
SC-110111P	430	250	390

Zero-point system - quatro

Unlocking air pressure: 0.6 MPa,With cleaning and gas detection

Clamping force: Single chuck can up to 15Q00N

Resetting precision: Less than 0.005mm

Characteristics: Can lift a 150kg pallet or a work piece by 1mm

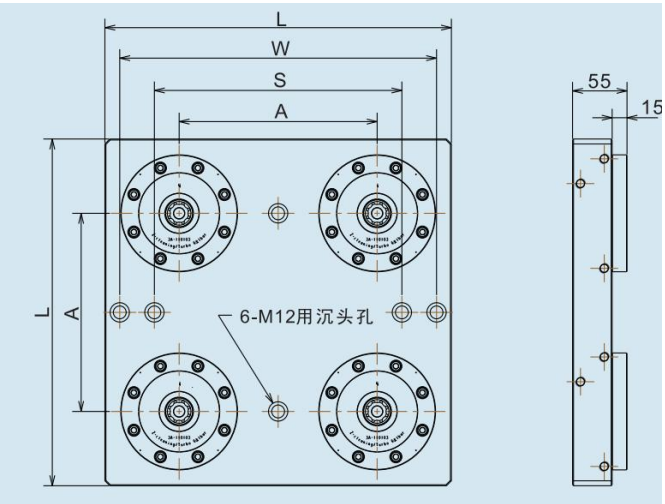

Model NO.	A(mm)	L(mm)	W(mm)	S(mm)
SC-110107P	200	350	320	250
SC-110108P	250	430	320	200

Zero-point system - Hexa

Unlocking air pressure: 0.6 MPa,With cleaning and gas detection

Clamping force: Single chuck can up to 15Q00N

Resetting precision: Less than 0.005mm

Note: Do not damage the air holes when drilling the connecting holes

Characteristics: Can lift a 150kg pallet or a workpiece by 1mm

Model NO	A(mm) (Center distance)	L(mm)	W(mm)
SC-110120P	200	600	380
SC-110121P	250	700	430

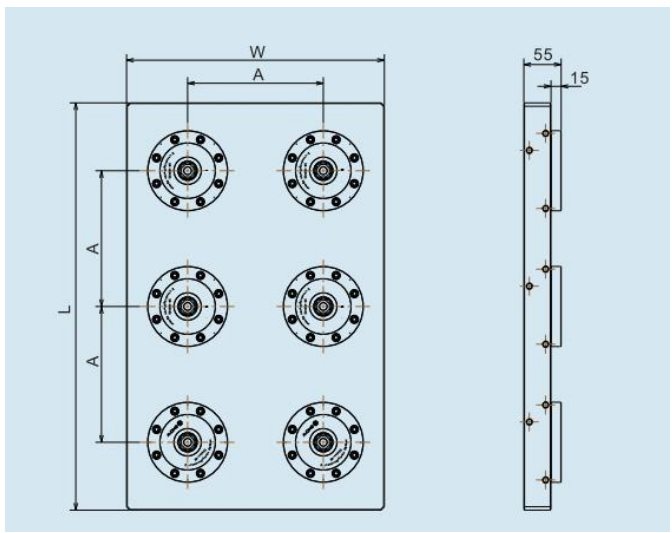

SC-110082

MC double-side zero point base block

Block material: FC30

Heat treatment: Bright Annealing

Function: Suitable for horizontal machining centre

Features:Zero-point chuck integrated on both sides;quick-change of fixtures or Work piece; standard interface, makes the production process much easier

Suitable for producing various products in large or small Can be customized according to customer's machine tool

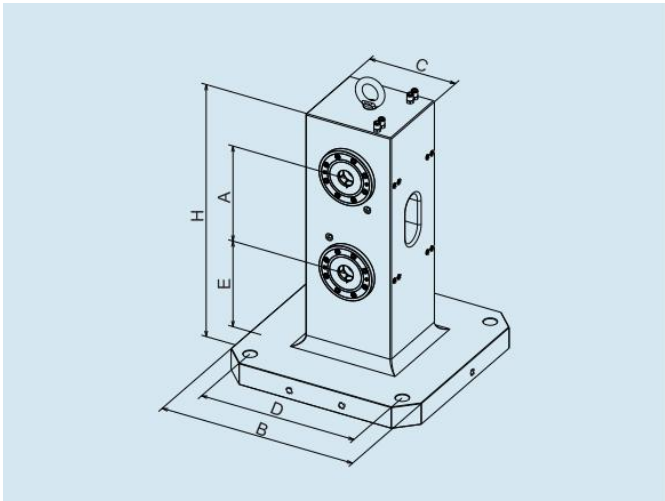

SC-10000818

Zero point chuck for two-link bridge

Version:Base plate, steel, unhardened

Connection:Side open: pneumatic

Application: The Zero point chuck for two-link bridge is installed on the four-axis

Note: Customizable

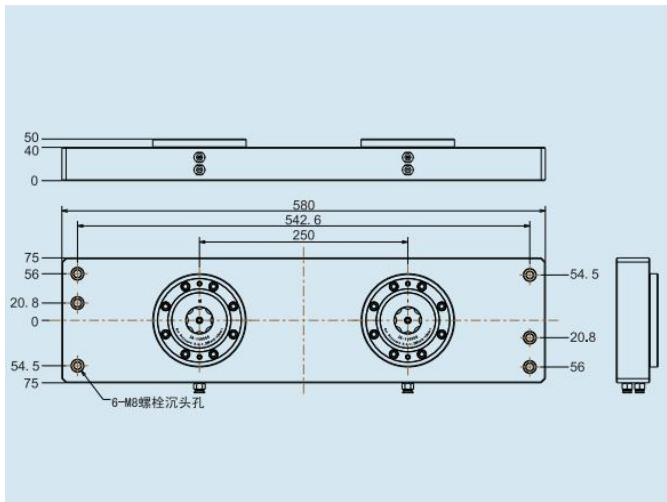

SC-10000824

Zero point chuck for two-link bridge

Version: Base plate, steel, unhardened

Connection: Side open: pneumatic

Application: The double-sided zero-point chuck is installed on the four-axis

Characteristic: The double-sided zero-point bridge can be configured with two pallets for processing, increasing the number of workstations and improving efficiency

Note: Customizable

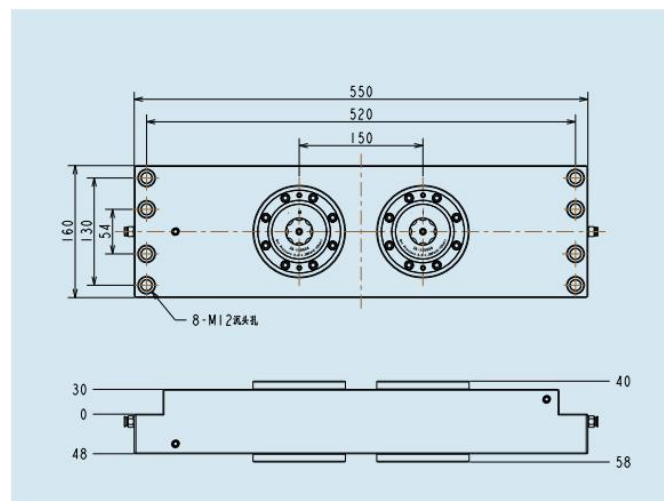

SC-10000887

Five joint zero point chuck

Version: Base plate, steel, unhardened

Connection: Side open: pneumatic

Application: Suitable for double pallets, directly installed on the machine table

Note: Customizable

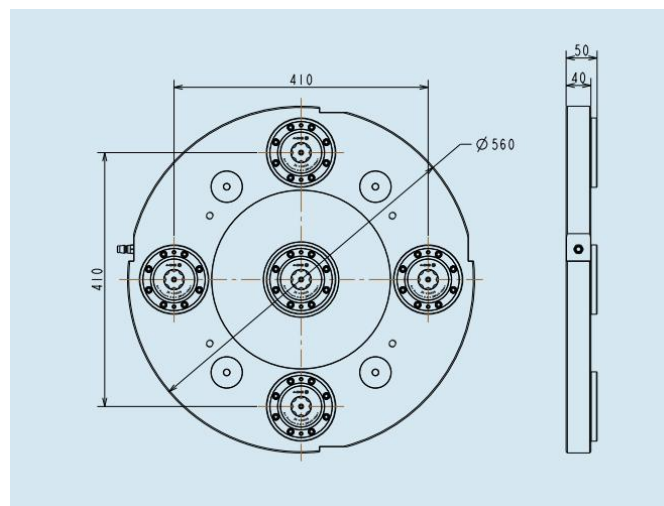

SC-10000154

Zero point square block

Version: Base plate, steel, unhardened

Connection: Side open: pneumatic

Application: Suitable for double pallets, directly installed on the machine table

Note: Customizable

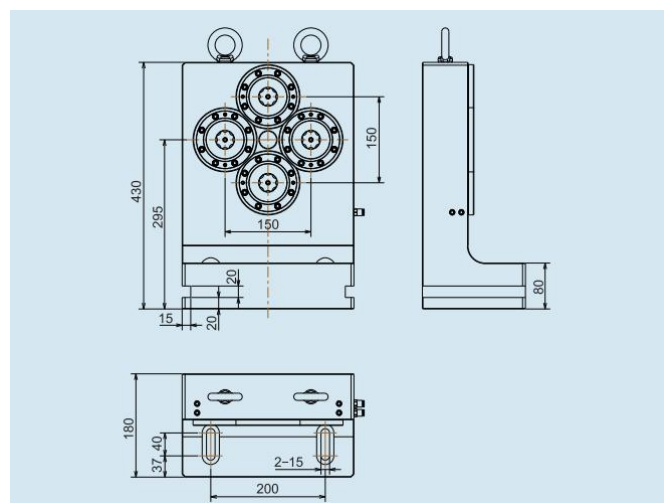

SC-1000891

Zero point square chuck- double

Version: Base plate, steel, unhardened

Connection: Side open: pneumatic

Application: Suitable for double pallets, directly installed on the machine table

Note: Customizable

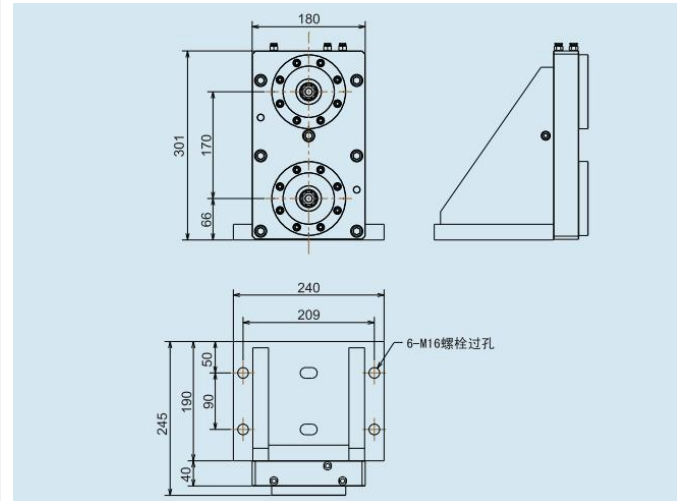

SC-110116

Reference pallet

Application: 1b correct and detect the mounting accuracy of the zero-point base

Precision: 0.002/100mm

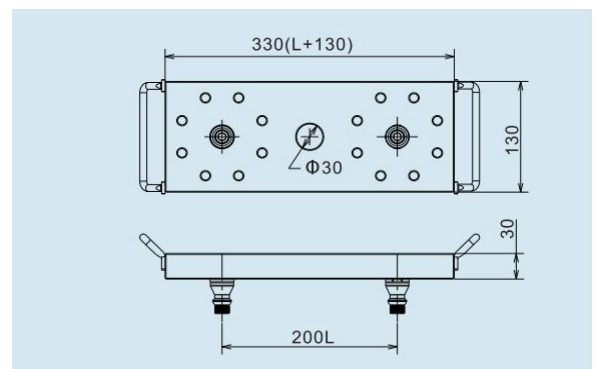

SC-400100

Centering spigot

Application: For center positioning

Mounting: Mounted on pallet or on the bottom of workpiece

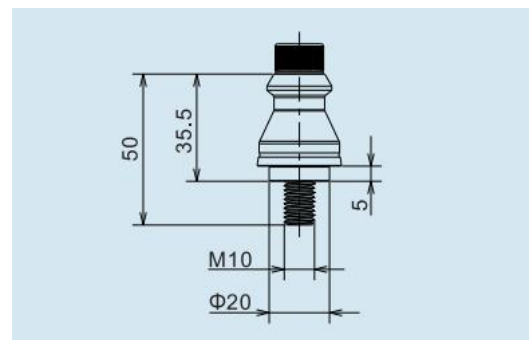

SC-400101

Compensation spigot

Application: For angular positioning

Mounting: Mounted on pallet or on the bottom of workpiece

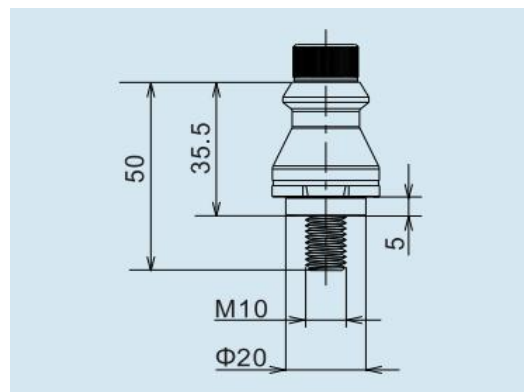

SC-400102

Chuckling spigot

Application: For auxiliary positioning

Mounting: Mounted on pallet or on the bottom of work piece

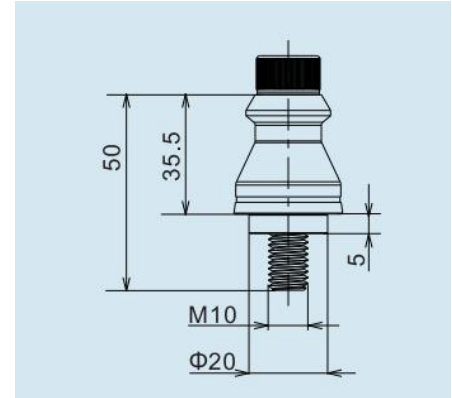

SC-110134

Single center zero point tray

Material: Aluminum alloy

Mounting: A positioning pull pin and a cylindrical pin have been installed Non-standard sizes can be customized

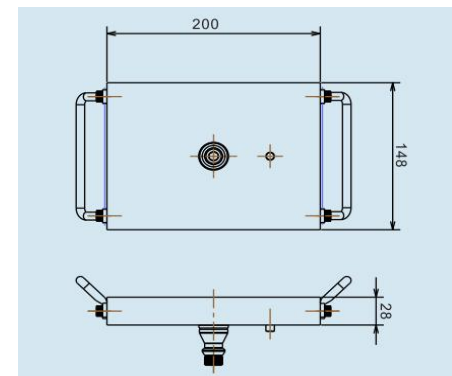

SC-110130/31/32

2-Fold Pallet

Material: Aluminum alloy

Mounting: 1 centering spigot, 1 compensation spigot

Model NO.	A(mm) (Center distance)	L(mm)	W(mm)	H(mm)
SC-110130	150	330	160	24
SC-110131	200	380	160	28
SC-110132	250	430	160	34

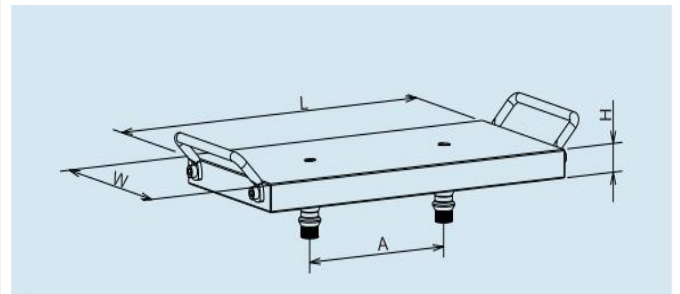

SC-110109/110133

4-Fold Pallet

Material: Aluminum alloy

Mounting: 1 centering spigot, 1 compensation spigot, 2chucking spigot

Model NO.	A(mm) (center distance)	L(mm)	H(mm)
SC-110109	200	380	34
SC-110133	250	430	38

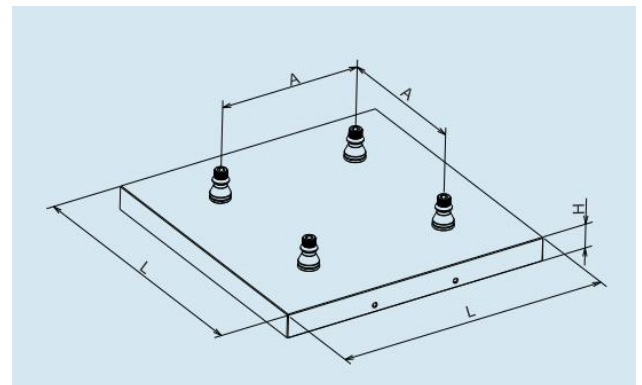



Quick Change Chuck

SC-100901

ITS chuck 100 p 102x102(without plate)

Version: Steel, hardened

Clamping Power: 6000N

Connection: At the rear with two lines

Operation: Air values

Application: Can be used with customized tools

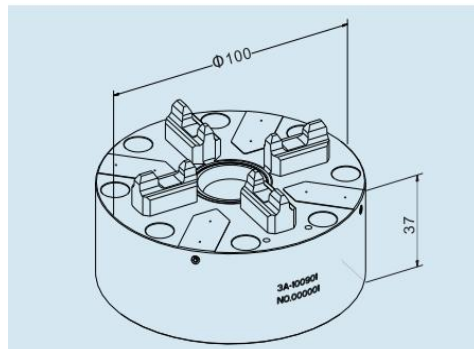

SC-100902

ITS chuck 100 p (without plate)

Version: Steel, hardened

Clamping Power: 6000N

Connection: At the rear with two lines

Operation: Air values

Application: Electrode holder and pallet with power centering plate can be mounted

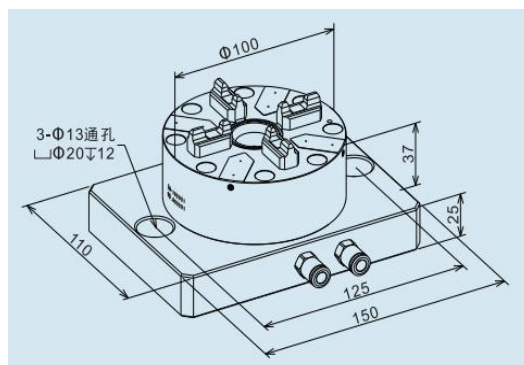

SC-100904

Rapid-action chuck 100 automatic

Version: Stainless steel, hardened, Repeat positioning accuracy of 0.002 mm

Clamping Power: 6000N

Connection: With air detection and anti reverse function .Side and bottom intake is available, Location hole at bottom Air valves

Operation: Air values

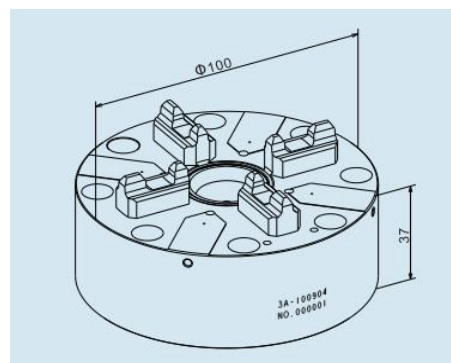

SC-100057

Rapid-action chuck 100 automatic (with plate)

Version: Stainless steel, hardened, Repeat positioning accuracy of 0.002 mm

Clamping Power: 6000N

Connection: With air detection and anti reverse function .Side and bottom intake is available, Location hole at bottom Air valves

Operation: Air values

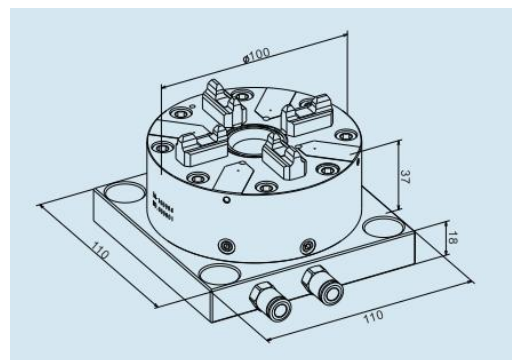

SC-100049

Power chuck 150

Version: 150 Powerful type. With plate. Mounting 4-M8 screw on the plate

Clamping Power: 10000N

Connection: With 2 air tubes on the side

Operation: Air values

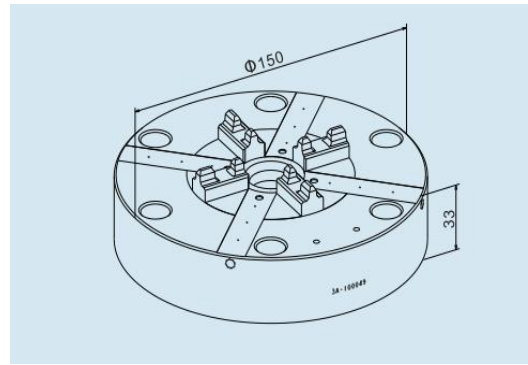

SC-100050

Power chuck 150(with plate)

Version: 150 Powerful type. With plate. Mounting 4-M8 screw on the plate

Clamping Power: 10000N

Connection: With 2 air tubes on the side

Operation: Air values

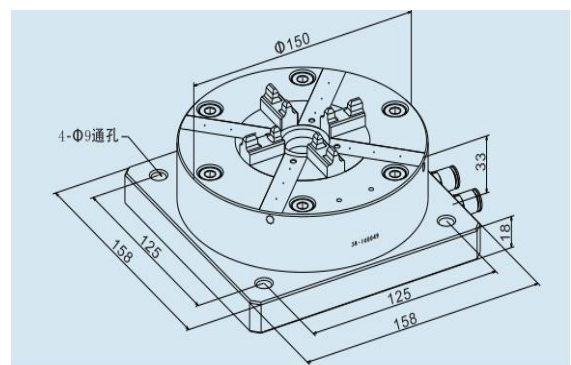

SC-100003

Quick chuck 100 P

Version: System size 100, manual, corrosion-resistant

Clamping Power: 10000N

Mounting: With four M8 bolts supplied

Application: Turning, milling, grinding or EDM/WEDM machines.in dividers and fixtures

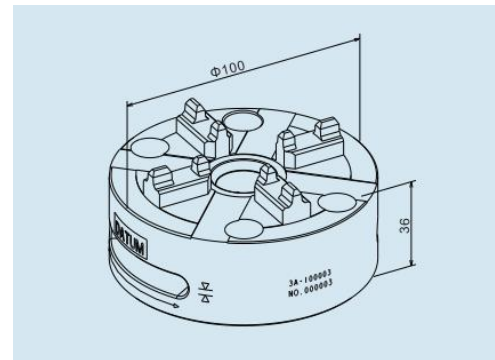

SC-100009

Quick chuck 100 P with base plate

Version: Corrosion-resistant, with plate

Clamping Power: 10000N

Mounting: With bolts or clamps

Operation: To be used on CNC lathe, Milling or grinding machine

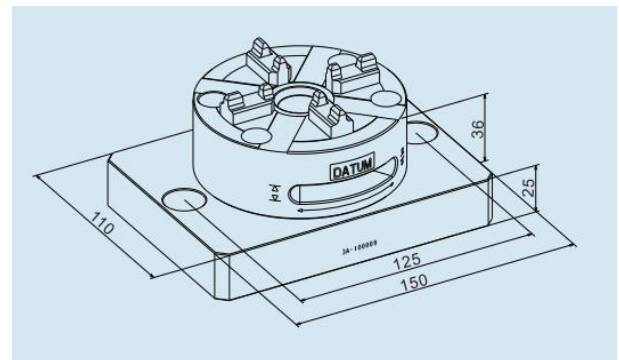

SC-100004

Square manual chuck

Version: System size 90, manual, corrosion-resistant 10000N

Clamping Power: 10000N

Mounting: With four M8 bolts supplied

Application: Turning, milling, grinding or EDM/WEDM machines, in dividers and fixtures

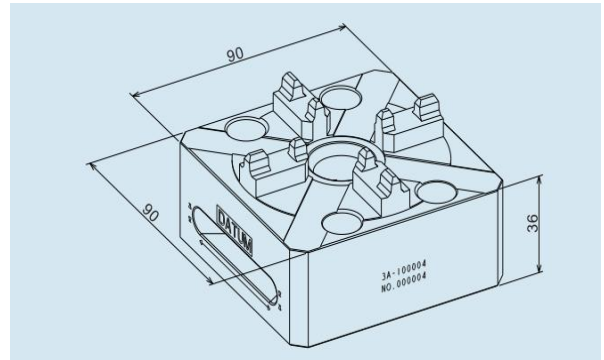

SC-100034

Single auto chuck-horizontal

Version: Power pneumatic lock.four sides of work piece can be machined,with chuck

Mounting:To be mounted directly on the table of machining center

Application: used on CNC machine center

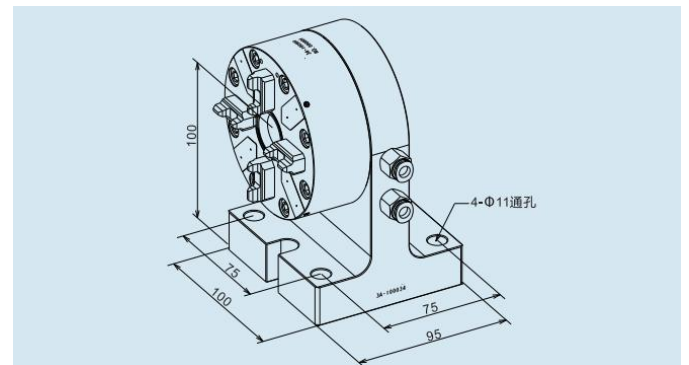

SC-100028

Square block for auto chuck

Version: Steel.hardened,corrosion-resistant

Application: For attaching 1 or 2 chucks SC-100901 in horizontal and vertical position

Note: Chuck supplied separately

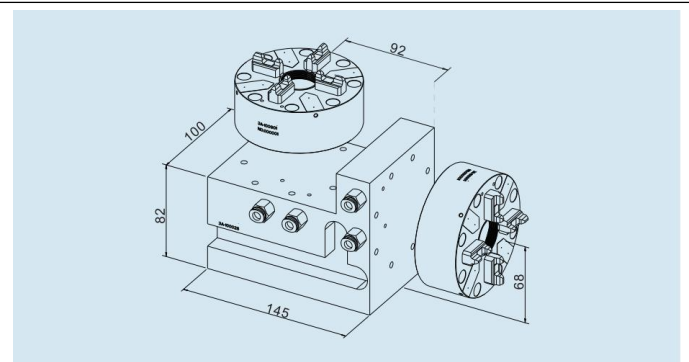

SC-100069

Square block for power auto chuck

Version: Steel.hardened,corrosion-resistant

Application: For attaching 1 or 2 chucks SC-100049 in horizontal and vertical position

Note: Chuck supplied separately

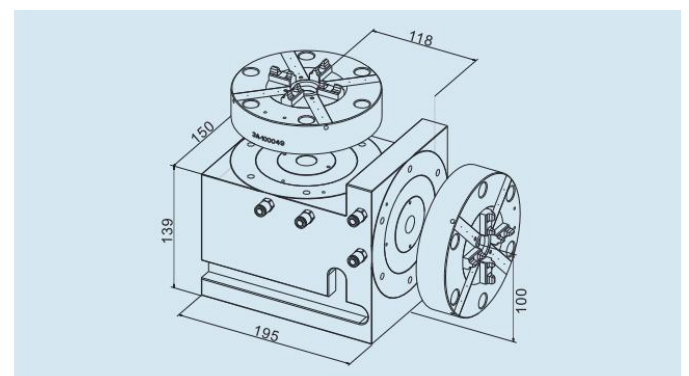

SC-100027

Square block for power manual chuck

Version: Steel.hardened,corrosion-resistant

Application: For attaching 1 or 2 chucks SC-100003 in horizontal and vertical position

Note: Chuck supplied separately

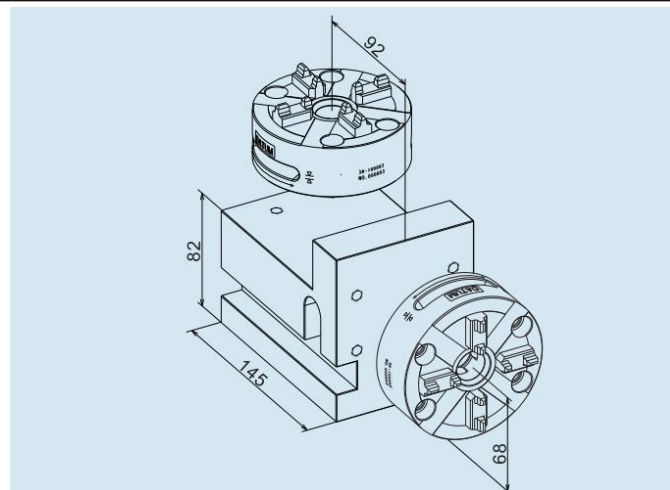

SC-10000349

Powerful T base plate

Version: Steel.hardened,corrosion-resistant

Mounting: To be mounted directly on the table of machining

Application: To be used on CNC machine center,Power pneumatic lock,four sides of workpiece can be machined,Chuck supplied separately

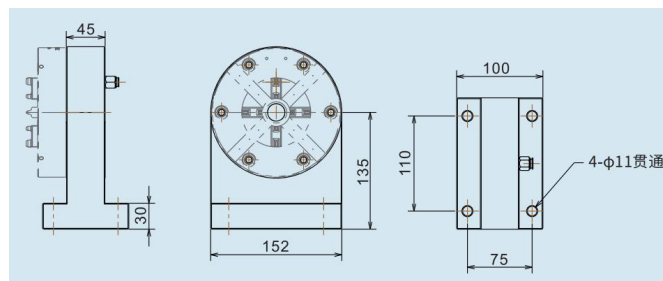

SC-110018

Pallet Kit $\phi 148G$

Version: Without bore holders apart from center borehole and borehole for reference bolt

Application: For workpieces machined in chip-cutting machining

Mounting: According to your preference

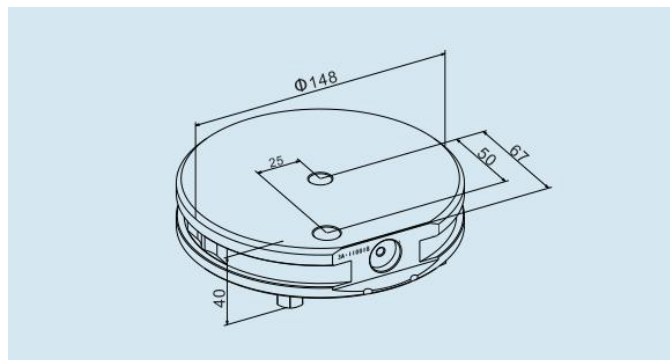

SC-110048

Pallet Kit $\phi 148$

Version: Steel, corrosion-resistant. Centering integrated in the pallet

Application: For used on all Power Chuck and Production Chuck 1b accommodate workpieces and fixtures in chip-cutting machining processes

Mounting: Through pallet with M8 bolts or through blank with M10 bolts

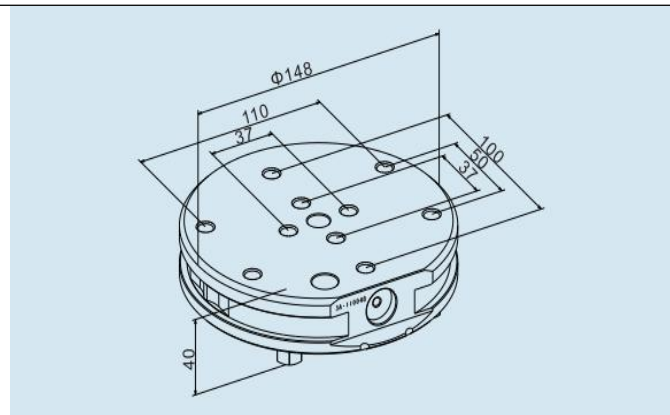

SC-110084

Pallet Kit $\phi 148G$

Version: Standard type

Application: To accommodate workpieces and fixtures in chipcutting machining processes

Mounting: Through pallet with M8 bolts or through blank with M10 bolts

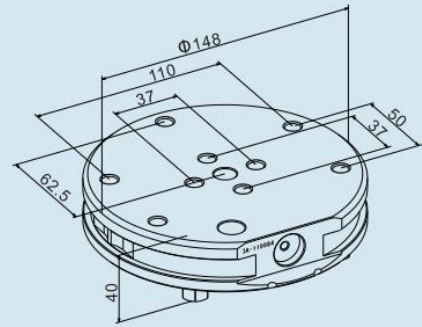

SC-110031

Collect chuck holder $\phi 72$

Version: One collect chuck holder with chucking spigot System

Application: To clamp cylindrical parts. Clamping range $\phi 2 \text{ mm} - \phi 20$

Note: Ordered collect chucks separately

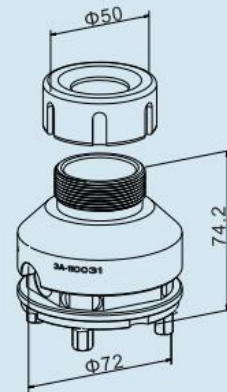

SC-400005

Spigot F/M production

Version: Fixed type, manual. Bolt 12.9, with flushing hole

Application: In Pallets for chip-cutting machining processes

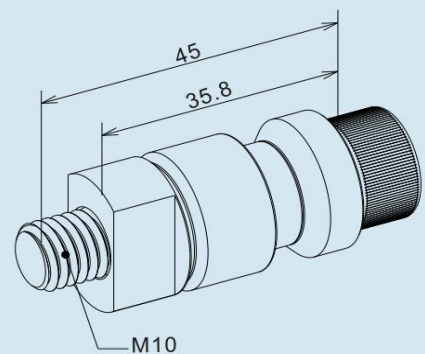

SC-400007

Chuckling spigot F/A Inox

Version: Fixed type, automatic. Bolt stainless, without flushing hole

Application: on all holders used on electrode library

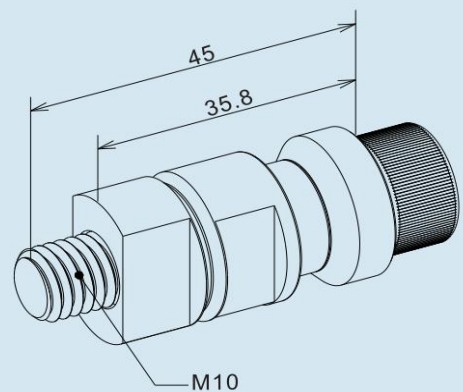

SC-400076

Chuckling spigot F/A Inox

Version: Fixed type, manual. Bolt 12.9, with flushing hole

Application: For Pallets with centering plate G(not built-in)

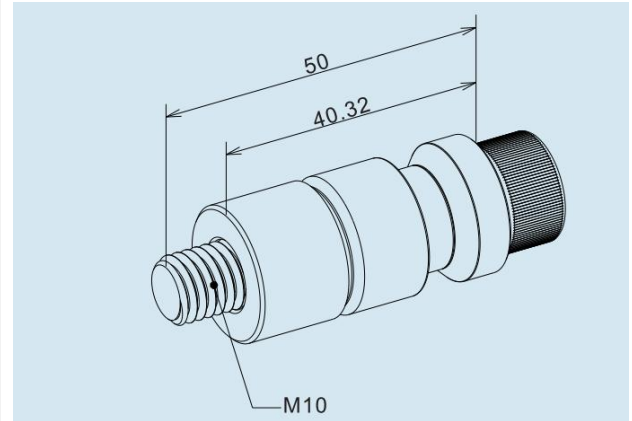

SC-400038

Spigot F/A EDM M10*45 for flushing

Version: Fixed type, automatic. Bolt with flushing hole

Application: For electrode holder ,for EDM and machining with light cutting force

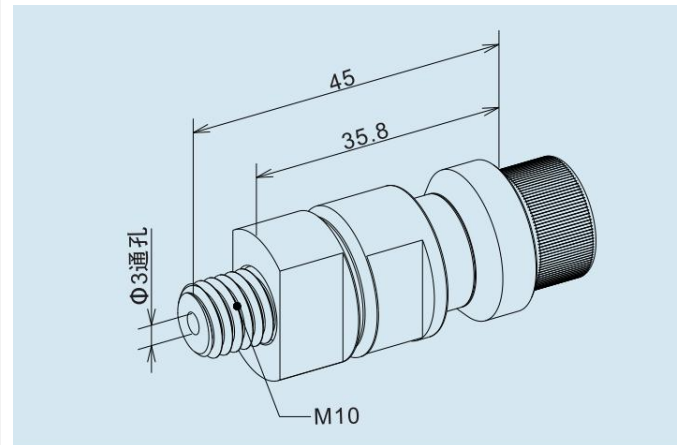

SC-400039

Spigot F/M EDM for flushing

Version: Fixed type, manual. Bolt 12.9, with flushing hole

Application: In Pallets for chip-cutting machining processes

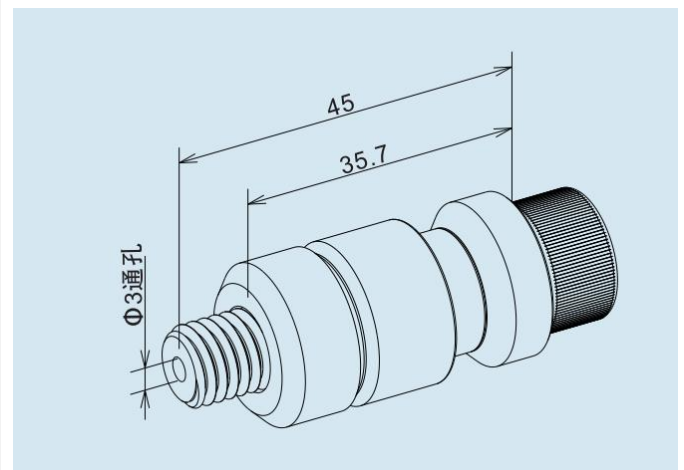

Standard components - Centering plates

The centering plates are the most cost-effective base for clamping electrodes. They are mounted directly onto the blanks or pallets. This way jigs and fixtures are also ITS compatible. The hole pattern for mounting is simply drilled into the blank with a drilling template or by means of an NC program.

Technical data	ITS centering plates
Material	corrosion-resistant
System accuracy in chuck	0.002mm
Versions:	
Centering plate 50	small electrode weights
Centering plate 100 M8	Work pieces and electrodes
Centering plate 100 G	Work pieces jigs and fixtures for chip-removal machining
Handling	With handling systems or electrode changer

SC-400001

Centering plate G Inox

Version: Ground, including 8 supporting feet M8

Application: For work pieces jigs and fixtures in chip-removal machining

Mounting: Reference installation instructions

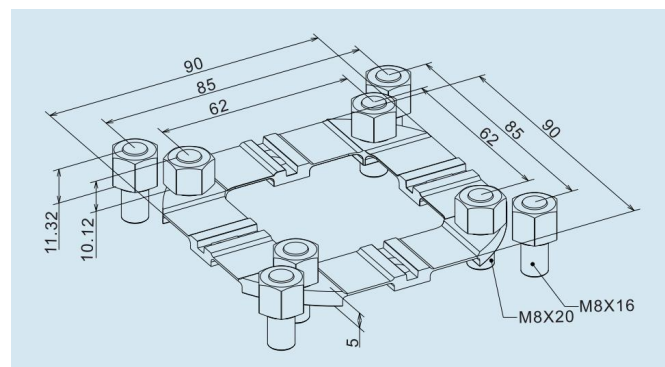

SC-400002

Centering plate 90 M8

Version: Ground, including 8 supporting feet M8

Application: Work pieces and electrodes

Mounting: Mounted on the electrode plate or workpiece, or on plane surface blank too

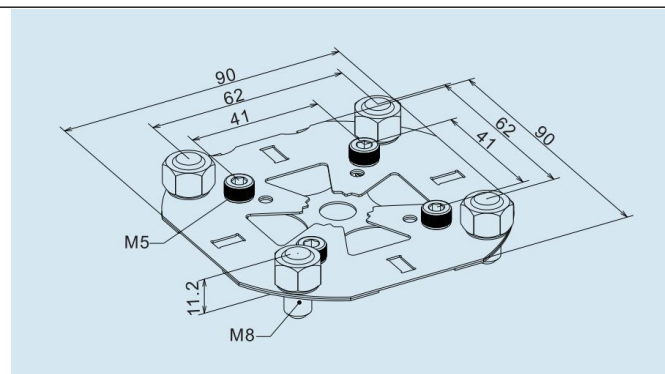

SC-400003

Centering plate 50

Version: Corrosion-resistant, including 4 supporting feet per plate

Application: Work pieces and electrodes

Mounting: Mounted on the electrode plate or workpiece, or on plane surface blank too

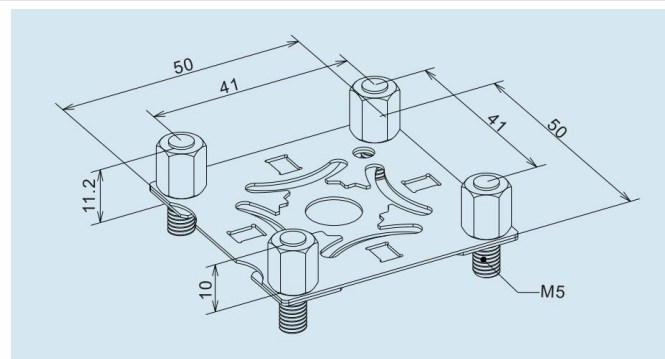

Zero point system examples

